

Track Application: N

Normal track application

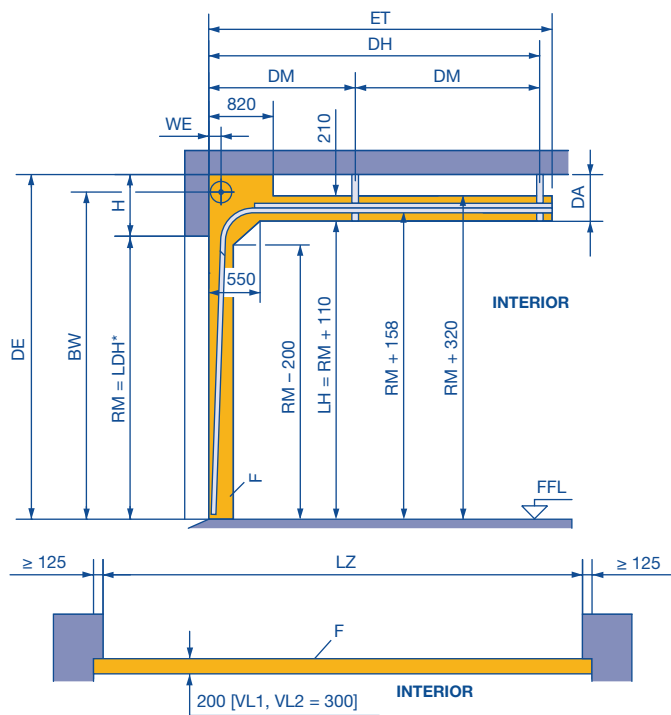

Door weights for roof loads:

SPU F42 / APU F42 Thermo / ALR F42 Thermo	= 320 N/m ²
APU F42 / ALR F42	= 280 N/m ²
ALR F42 Glazing	= 560 N/m ²

Observe min. sideroom, see page 61.

	H	WE	DA
N 1	390	140	280
N 2	440	160	330
N 3	550	180	440
N 3	760	With double spring shaft	

LDH	Clear passage height	L	Anchor length = DE - RM - 125 (see page 66)
RM	Grid height	LH	Track height
BW	Position of shaft support	LZ	Clear frame dimensions
	N 1 = RM + 310	DE	Ceiling height
	N 2 = RM + 335	F	Space for fitting the door
	N 3 = RM + 415		
ET	Min. distance back		
	N 1 + N 2 = RM + 440		
	N 3 = RM + 700		
	With shaft operator		
	N 1 + N 2 = RM + 650		
	With shaft operator N 3 = RM + 700		
DH	Rear ceiling anchor		
	N 1 + N 2 = RM + 195		
	N 3 = RM + 295		
DM	Central ceiling anchor (see page 66)		
WE	Shaft centre from lintel		
H	Min. headroom (see table)		
DA	Distance to ceiling		

Notes:

- Observe the permissible size ranges of the door types on pages 10 – 18 and 21 – 32 under all circumstances!
- The clearance required for fitting the door must be free of supply lines, heater fans, etc.
- For version with wicket door, manually operated: chain hoist recommended!
- ALR F42 Vitraplan and ALR F42 Glazing on request

	* Clear passage height LDH		
	Without operator	Operator	
		WA 400 **	WA 300 ***
LZ ≤ 5500			
Without wicket door	RM	RM	RM
Wicket door with threshold	RM - 100	RM - 50	RM - 50
Wicket door without threshold rail	RM - 150	RM - 85	RM - 85
LZ > 5500			
Without wicket door	RM - 50	RM - 50	RM - 50
Wicket door with threshold	RM - 100	RM - 100	RM - 100
Wicket door without threshold rail	RM - 175	RM - 110	RM - 110

** Or with chain hoist / pull rope

*** Track application with inclination not possible!

Min. headroom

Track size	Headroom	Track size	Headroom	Track size	Headroom
N 1	390	GD 2	660 – 790	RD 4	1760
N 2	440	L 1	200	RD 5	1760
N 3	550	L 2	200	RG 4	1760
NA 1	400	LD 1	200	RG 5	1760
NA 2	450	LD 2	200	V 6	RM + 500
ND 1	390	H 4	880	V 7	RM + 540
ND 2	440	H 5	910	V 9	RM + 635
ND 3	550	H 8	950	VA 6	RM + 510
NH 1	610 – 740	HA 4	890	VU 6	RM + 350
NH 2	660 – 790	HD 4	880	VU 7	RM + 350
NH 3	770 – 900	HD 5	910	VU 9	RM + 350
NS 1	390	HD 8	950	WG 6	RM + 350
NS 2	440	HU 4	1760	WG 7	RM + 350
GD 1	610 – 740	HU 5	1760		

Dimensions in mm

Track Application: L

Low headroom track application

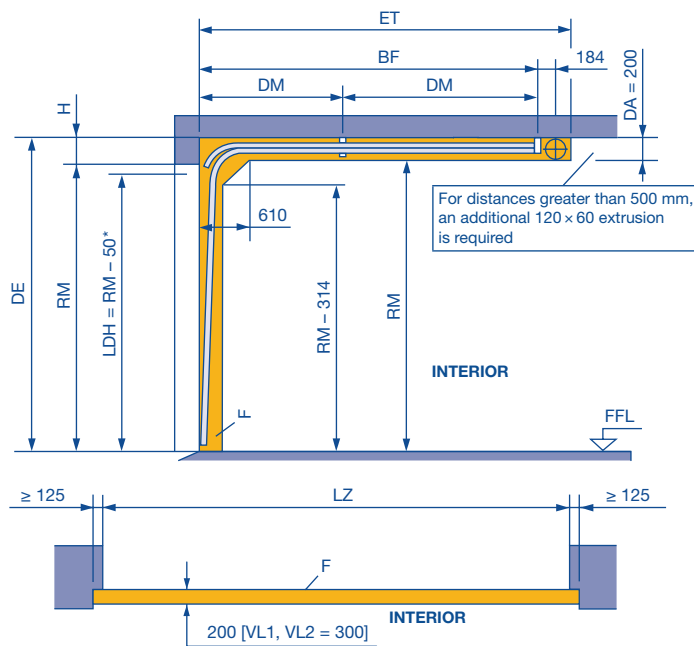

Door weights for roof loads:

SPU F42 / APU F42 Thermo / ALR F42 Thermo	= 320 N/m ²
APU F42 / ALR F42	= 280 N/m ²
ALR F42 Glazing	= 560 N/m ²

Observe min. sideroom, see page 61.

Door operation:

- Manually operated: with rope or chain hoist (recommended for manual operation!)
- Power-driven: WA 400 with chain box, ITO 400 or SupraMatic H

	* Clear passage height LDH		
	Without operator	Operator	
		WA 400 **	WA 300 ***
LZ ≤ 5500			
Without wicket door	RM - 50	RM - 50	RM - 80
Wicket door with threshold	RM - 100	RM - 100	RM - 130
Wicket door without threshold rail	RM - 165	RM - 135	RM - 165
LZ > 5500			
Without wicket door	RM - 100	RM - 100	RM - 130
Wicket door with threshold	RM - 100	RM - 100	RM - 130
Wicket door without threshold rail	RM - 195	RM - 165	RM - 195

** Or with chain hoist / pull rope

*** Track application with inclination not possible!

Notes:

- The clearance required for fitting the door must be free of supply lines, heater fans, etc.
- Observe the permissible size ranges of the door types on pages 10 - 18 and 21 - 32 under all circumstances!
- ALR F42 Vitraplan and ALR F42 Glazing on request

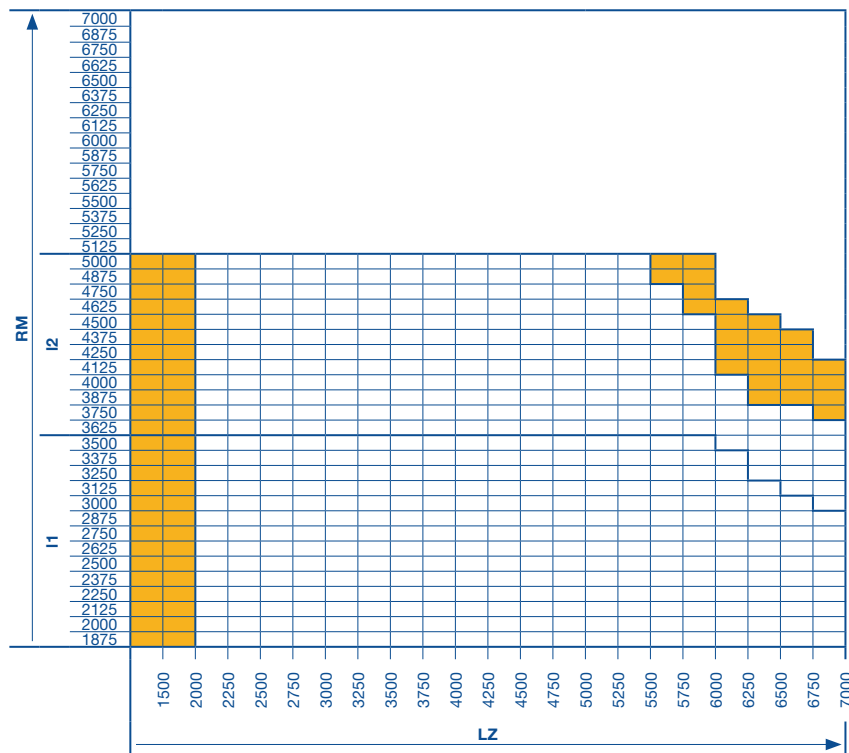

- LDH** Clear passage height
- RM** Grid height
- BF** Position of spring shaft = RM + 682
- DM** Central ceiling anchor
Up to RM 3500 = BF / 2
From RM 3510 = BF / 3
- ET** Min. distance back = RM + 990
- H** Min. headroom 200 (see page 42)
- DA** Distance to ceiling
- DE** Ceiling height
- L** Anchor length = DE - RM - 15 (see page 66)
- LZ** Clear frame dimensions (from 1200)
- F** Space for fitting the door

□ All door types available in any version.

■ All door types in any version on request.

Dimensions in mm

Track Application: LD

Low headroom track application

With inclination

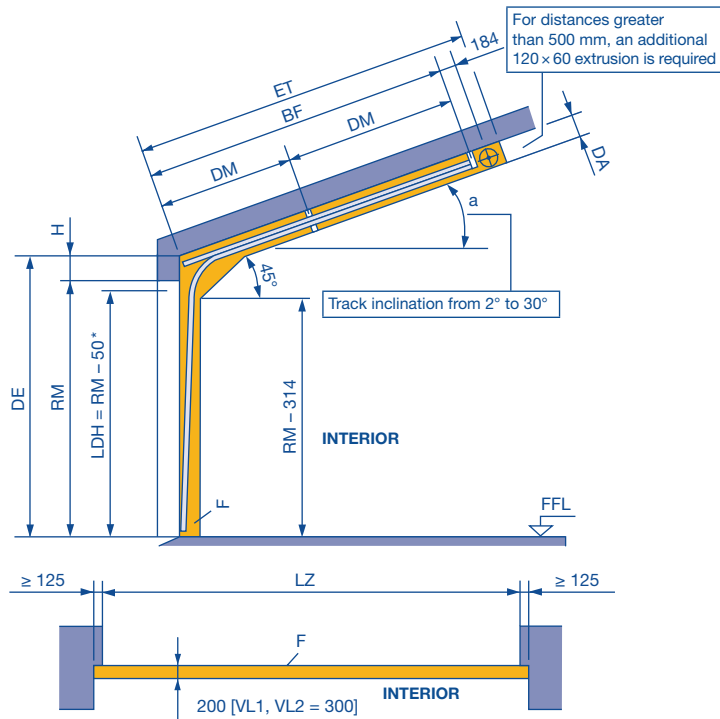

Door weights for roof loads:

SPU F42 / APU F42 Thermo / ALR F42 Thermo	= 320 N/m ²
APU F42 / ALR F42	= 280 N/m ²
ALR F42 Glazing	= 560 N/m ²

Observe min. sideroom, see page 61.

Only to determine the roof slope in degrees (a°)		
a°	%	X (mm)
2	3.49	34.9
4	6.99	69.9
6	10.51	105.1
8	14.05	140.5
10	17.63	176.3
12	21.26	212.6
14	24.93	249.3
16	28.67	286.7
18	32.49	324.9
20	36.40	364.0
22	40.40	404.0
24	44.52	445.2
26	48.77	487.7
28	53.17	531.7
30	57.74	577.4

* Notes:

- Clear passage height LDH, see track application L
- For door operation, see track application L

Notes:

- The clearance required for fitting the door must be free of supply lines, heater fans, etc.
- Observe the permissible size ranges of the door types on pages 10 – 18 and 21 – 32 under all circumstances!
- ALR F42 Vitraplan and ALR F42 Glazing on request

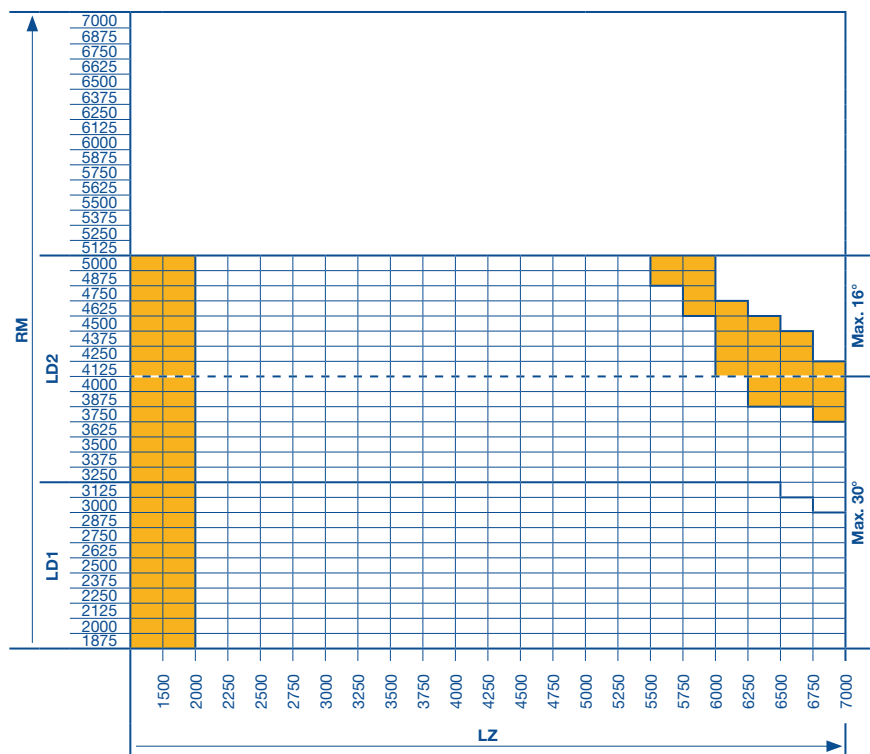

- LDH** Clear passage height
- RM** Grid height
- ET** Min. distance back
 - 2° – 4° = RM + 990
 - 6° – 16° = RM + 800
 - 18° – 30° = RM + 740
- H** Min. headroom 200 (see page 42)
- BF** Position of spring shaft on request
- DM** Central ceiling anchor on request
- DA** Distance to ceiling on request
- DE** Ceiling height
- L** Anchor length on request (see page 66)
- LZ** Clear frame dimensions (from 1200)
- F** Space for fitting the door

- All door types available in any version.
- All door types in any version on request.

Dimensions in mm