

# Track Application: N

## Normal track application

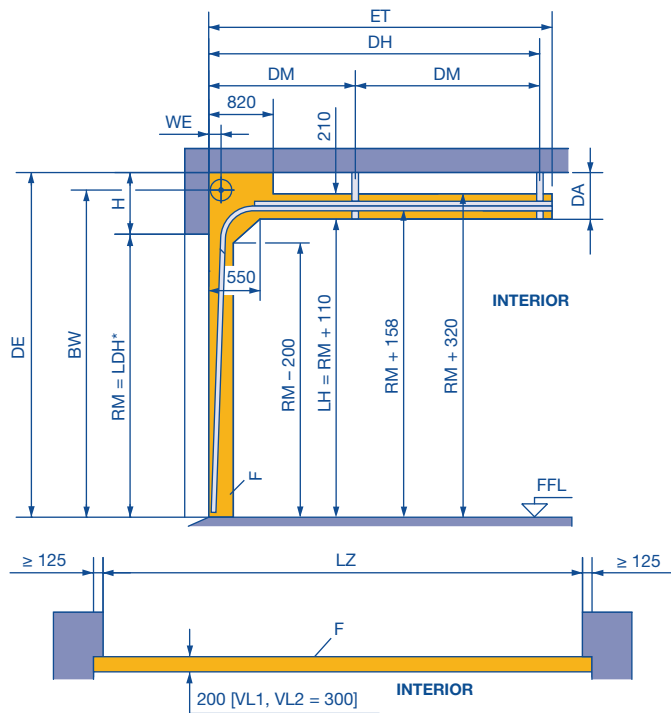

### Door weights for roof loads:

SPU F42 / APU F42 Thermo / ALR F42 Thermo	= 320 N/m <sup>2</sup>
APU F42 / ALR F42	= 280 N/m <sup>2</sup>
ALR F42 Glazing	= 560 N/m <sup>2</sup>

Observe min. sideroom, see page 61.

	H	WE	DA
N 1	390	140	280
N 2	440	160	330
N 3	550	180	440
N 3	760	With double spring shaft	

<b>LDH</b>	Clear passage height	<b>L</b>	Anchor length = DE - RM - 125 (see page 66)
<b>RM</b>	Grid height	<b>LH</b>	Track height
<b>BW</b>	Position of shaft support	<b>LZ</b>	Clear frame dimensions
	N 1 = RM + 310	<b>DE</b>	Ceiling height
	N 2 = RM + 335	<b>F</b>	Space for fitting the door
	N 3 = RM + 415		
<b>ET</b>	Min. distance back		
	N 1 + N 2 = RM + 440		
	N 3 = RM + 700		
	With shaft operator		
	N 1 + N 2 = RM + 650		
	With shaft operator N 3 = RM + 700		
<b>DH</b>	Rear ceiling anchor		
	N 1 + N 2 = RM + 195		
	N 3 = RM + 295		
<b>DM</b>	Central ceiling anchor (see page 66)		
<b>WE</b>	Shaft centre from lintel		
<b>H</b>	Min. headroom (see table)		
<b>DA</b>	Distance to ceiling		

### Notes:

- Observe the permissible size ranges of the door types on pages 10–18 and 21–32 under all circumstances!
- The clearance required for fitting the door must be free of supply lines, heater fans, etc.
- For version with wicket door, manually operated: chain hoist recommended!
- ALR F42 Vitraplan and ALR F42 Glazing on request

	* Clear passage height LDH		
	Without operator	Operator	
		WA 400 **	WA 300 ***
<b>LZ ≤ 5500</b>			
Without wicket door	RM	RM	RM
Wicket door with threshold	RM - 100	RM - 50	RM - 50
Wicket door without threshold rail	RM - 150	RM - 85	RM - 85
<b>LZ &gt; 5500</b>			
Without wicket door	RM - 50	RM - 50	RM - 50
Wicket door with threshold	RM - 100	RM - 100	RM - 100
Wicket door without threshold rail	RM - 175	RM - 110	RM - 110

\*\* Or with chain hoist / pull rope

\*\*\* Track application with inclination not possible!

### Min. headroom

Track size	Headroom	Track size	Headroom	Track size	Headroom
N 1	390	GD 2	660–790	RD 4	1760
N 2	440	L 1	200	RD 5	1760
N 3	550	L 2	200	RG 4	1760
NA 1	400	LD 1	200	RG 5	1760
NA 2	450	LD 2	200	V 6	RM + 500
ND 1	390	H 4	880	V 7	RM + 540
ND 2	440	H 5	910	V 9	RM + 635
ND 3	550	H 8	950	VA 6	RM + 510
NH 1	610–740	HA 4	890	VU 6	RM + 350
NH 2	660–790	HD 4	880	VU 7	RM + 350
NH 3	770–900	HD 5	910	VU 9	RM + 350
NS 1	390	HD 8	950	WG 6	RM + 350
NS 2	440	HU 4	1760	WG 7	RM + 350
GD 1	610–740	HU 5	1760		

Dimensions in mm

# Track Application: V

## Vertical track application

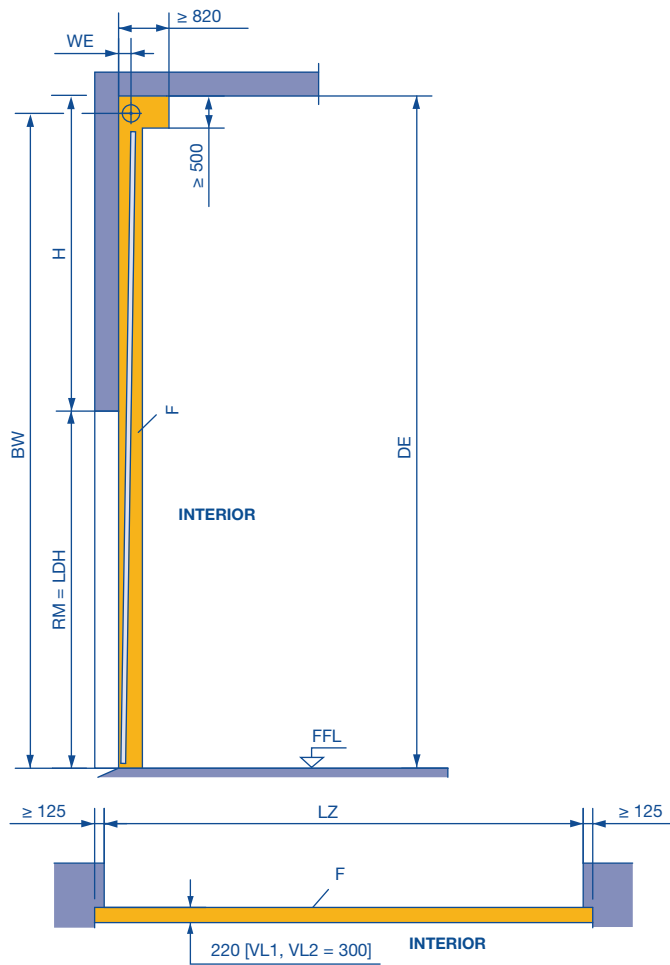

### Notes:

- The clearance required for fitting the door must be free of supply lines, heater fans, etc.
- Observe the permissible size ranges of the door types on pages 10 – 18 and 21 – 32 under all circumstances!

Observe min. sideroom, see page 61.

<b>LDH</b>	Clear passage height
<b>RM</b>	Grid height
<b>WE</b>	Shaft centre from lintel V 6 = 160, V 7 = 180
<b>H</b>	Min. headroom (see page 42)
<b>DE</b>	Ceiling height 2 × RM + 500 (V 6) 2 × RM + 540 (V 7) 2 × RM + 730 (V 7 with double spring shaft) 2 × RM + 635 (V 9) 2 × RM + 780 (V 9 with double spring shaft)
<b>BW</b>	Position of shaft support 2 × RM + 360 (V 6) 2 × RM + 385 (V 7) 2 × RM + 435 (V 9)
<b>LZ</b>	Clear frame dimensions (from 1200)
<b>F</b>	Space for fitting the door

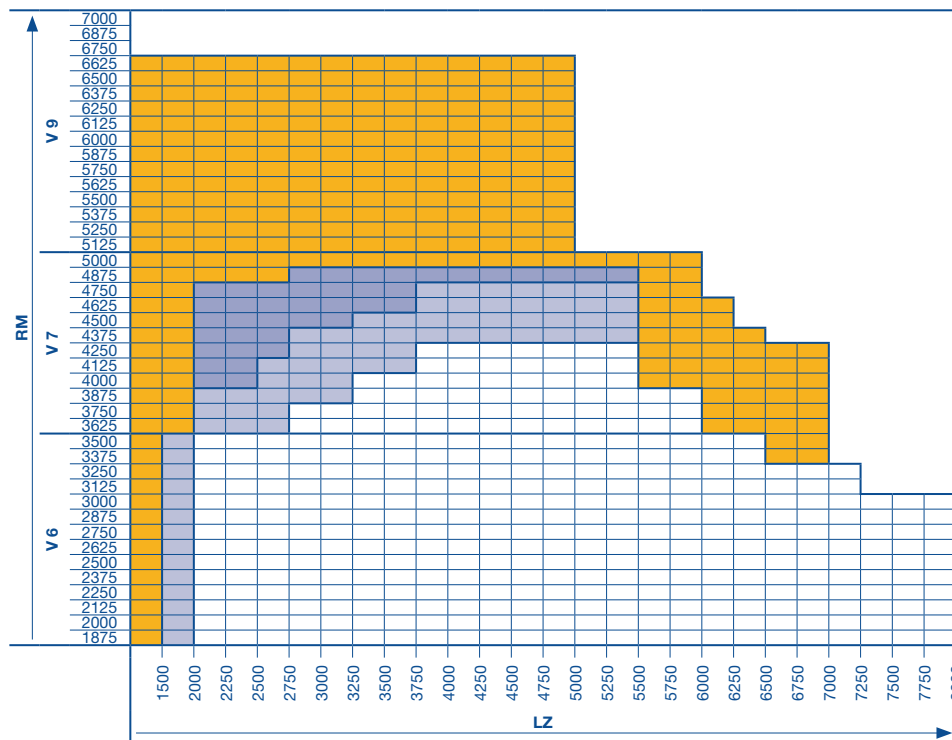

### Note:

ALR F42 Vitraplan and ALR F42 Glazing on request

- All door types available in any version.
- All door types available, versions with glazing A3, B3, M3, S3, LB, P and / or wicket door on request.
- Door types APU F42 S-Line, ALR F42 S-Line, APU F42 and ALR F42 are possible; APU F42 Thermo, ALR F42 Thermo and SPU F42 with thermo frames as well as versions with glazing A3, B3, M3, S3, LB, P and / or wicket door on request.
- All door types in any version on request.

Dimensions in mm

# Track Application: VA

## Vertical track application

### With high-mounted torsion spring shaft

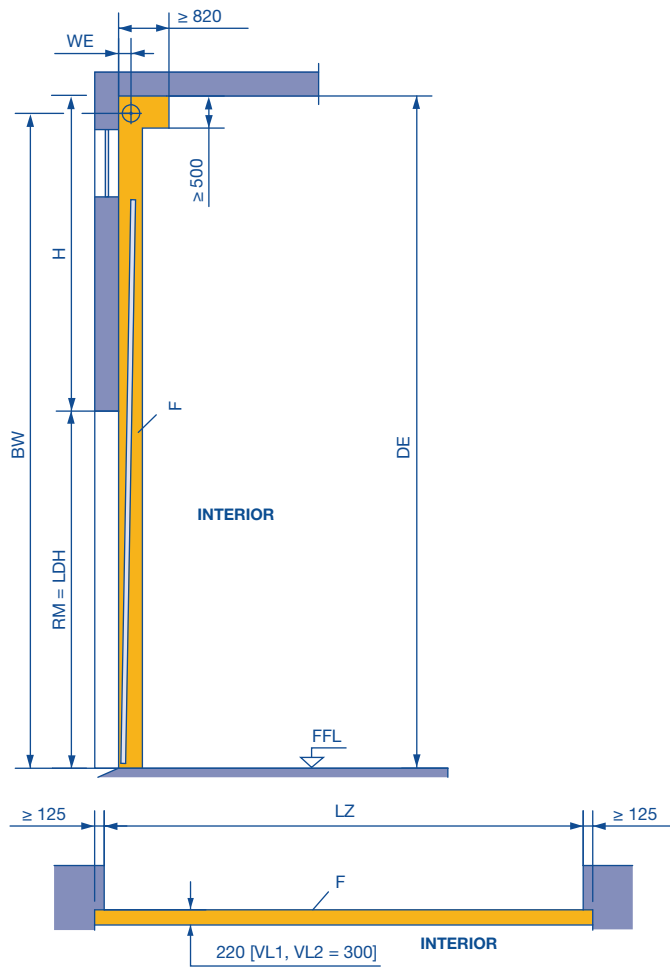

#### Notes:

- The clearance required for fitting the door must be free of supply lines, heater fans, etc.
- Observe the permissible size ranges of the door types on pages 10 – 18 and 21 – 32 under all circumstances!

Observe min. sideroom, see page 61.

<b>LDH</b>	Clear passage height
<b>RM</b>	Grid height
<b>WE</b>	Shaft centre from lintel VA 6 = 160
<b>H</b>	Min. headroom (see page 42)
<b>DE</b>	Ceiling height Min.: $2 \times RM + 510$ (VA 6) Max.: depends on order
<b>BW</b>	Position of shaft support= Min.: $2 \times RM + 370$ (VA 6) Max.: $7895 = DE - 140$
<b>LZ</b>	Clear frame dimensions ( <b>from 1200</b> )
<b>F</b>	Space for fitting the door

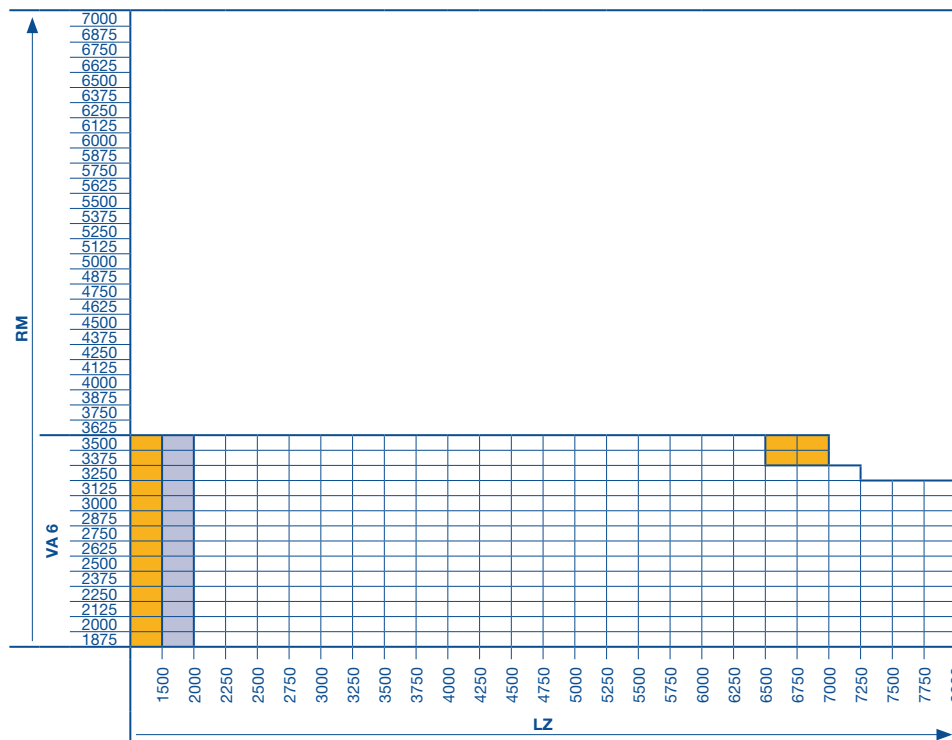

#### Note:

ALR F42 Vitraplan and  
ALR F42 Glazing on request

- All door types available in any version.
  - All door types available, versions with glazing A3, B3, M3, S3, LB, P and / or wicket door on request.
  - All door types in any version on request.
- Dimensions in mm

# Track Application: VU

## Vertical track application

### With low-mounted torsion spring shaft

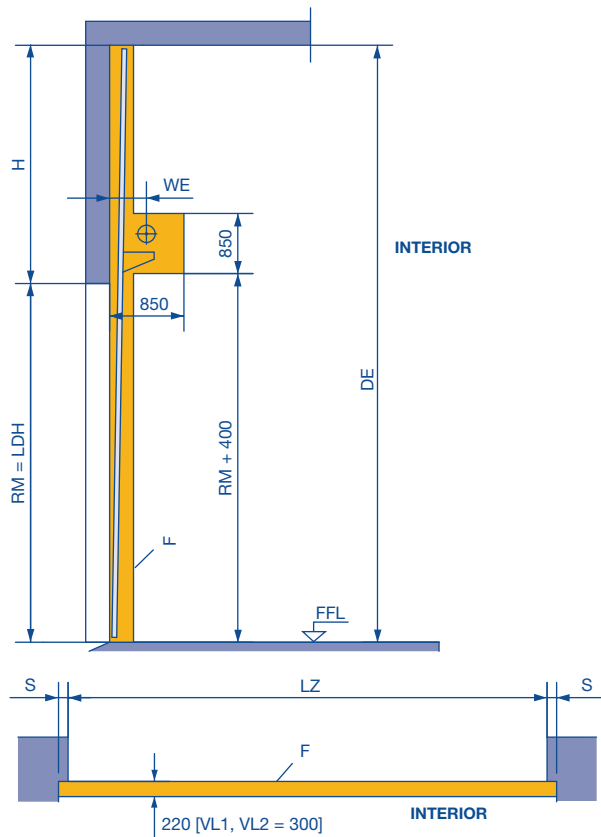

#### Notes:

- The clearance required for fitting the door must be free of supply lines, heater fans, etc.
- Observe the permissible size ranges of the door types on pages 10–18 and 21–32 under all circumstances!

Track application	S
VU 6	125
VU 7, VU 9	140

Observe min. sideroom, see page 61.

- DE** Ceiling height =  $2 \times RM + 350$   
**WE** Shaft centre from lintel  
 VU 6 = 315  
 VU 7 = 335  
 VU 9 = 375  
**H** Min. headroom (see page 42)  
**LDH** Clear passage height  
**RM** Grid height  
**LZ** Clear frame dimensions (from 1200)  
**F** Space for fitting the door  
**S** Min. sideroom

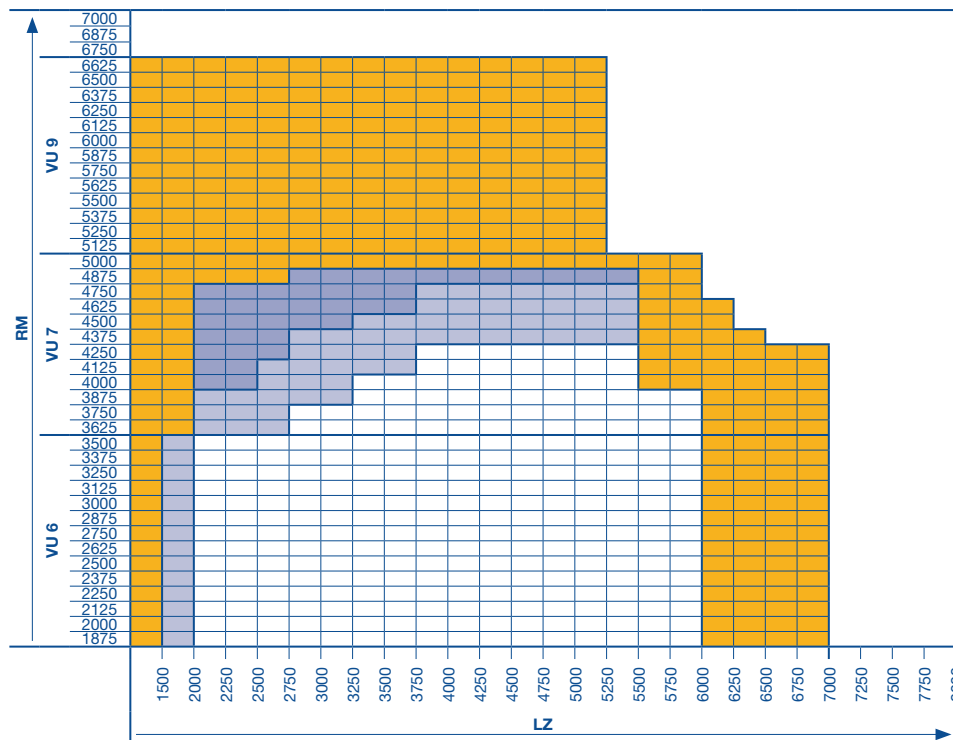

#### Note:

ALR F42 Vitraplan and  
 ALR F42 Glazing on request

- All door types available in any version.
- All door types available, versions with glazing A3, B3, M3, S3, LB, P and/or wicket door on request.
- Door types APU F42 S-Line, ALR F42 S-Line, APU F42 and ALR F42 are possible; APU F42 Thermo, ALR F42 Thermo and SPU F42 with thermo frames as well as versions with glazing A3, B3, M3, S3, LB, P and/or wicket door on request.
- All door types in any version on request.

Dimensions in mm

# Track Application: WG

## Vertical track application

### With low-mounted torsion spring shaft and steep track

(Application for loading ramp doors)

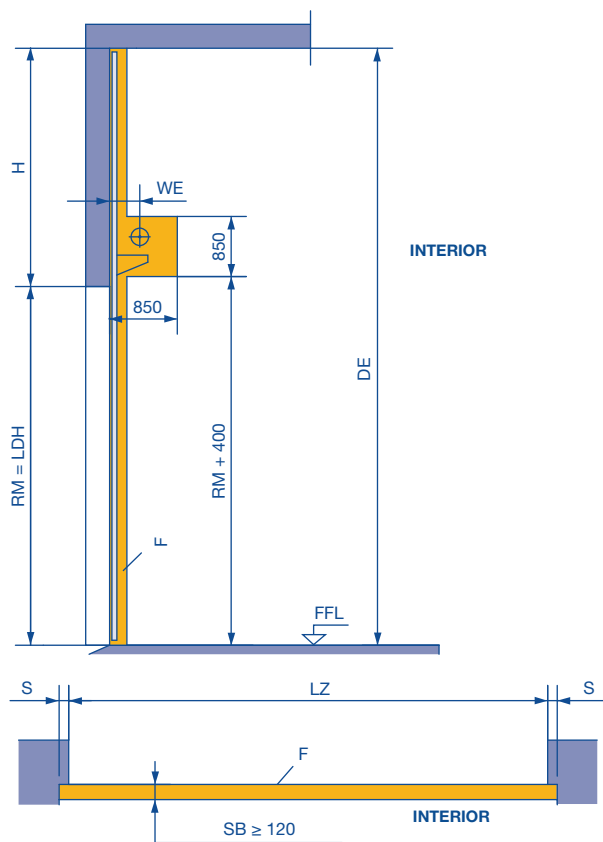

#### Notes:

- Door types APU F42 S-Line / ALR F42 S-Line and wicket doors are not possible!
- The clearance required for fitting the door must be free of supply lines, heater fans, etc.
- Observe the permissible size ranges of the door types on pages 10–18 and 21–32 under all circumstances!

Track application	S
WG 6	125
WG 7	140

Observe min. sideroom, see page 61.

- DE** Ceiling height =  $2 \times RM + 350$
- WE** Shaft centre from lintel  
WG 6 = 246  
WG 7 = 276
- H** Min. headroom (see page 42)
- SB** Slot width
- LDH** Clear passage height
- RM** Grid height
- LZ** Clear frame dimensions (from 1200)
- F** Space for fitting the door
- S** Min. sideroom

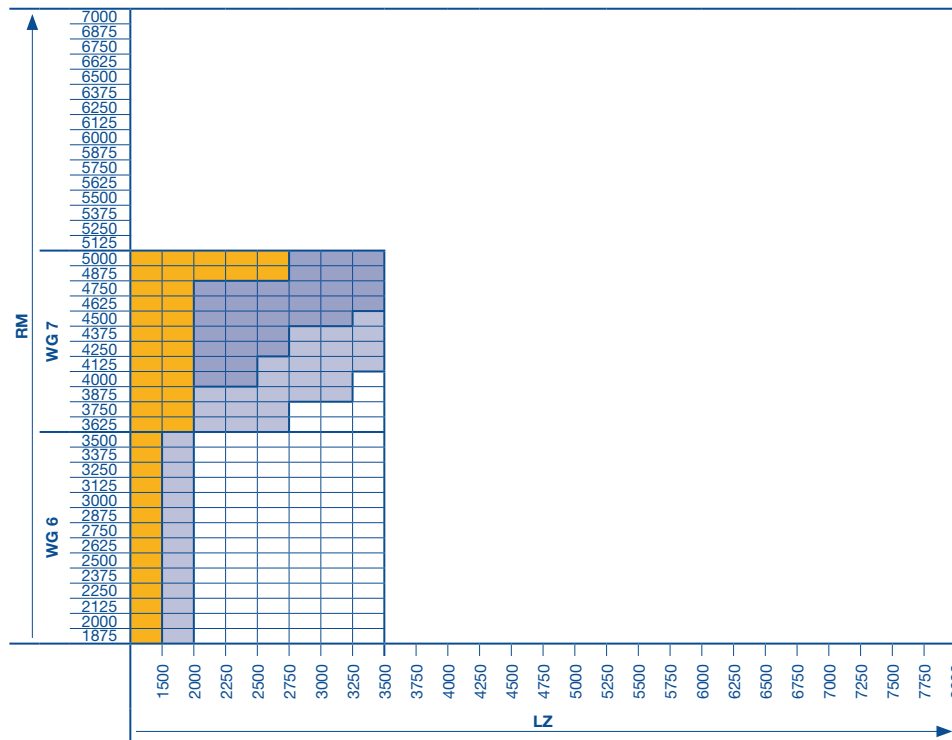

#### Note:

ALR F42 Vitraplan and ALR F42 Glazing on request

- All door types available in any version.
- All door types available, versions with glazing A3, B3, M3, S3, LB, P on request.
- Door types APU F42 S-Line, ALR F42 S-Line, APU F42 and ALR F42 are possible; APU F42 Thermo, ALR F42 Thermo and SPU F42 with thermo frames as well as versions with glazing A3, B3, M3, S3, LB, P must be requested.
- All door types in any version on request.

Dimensions in mm